

		REVISIONS			
ZONE	REV.	DESCRIPTION		DATE	APPROVED

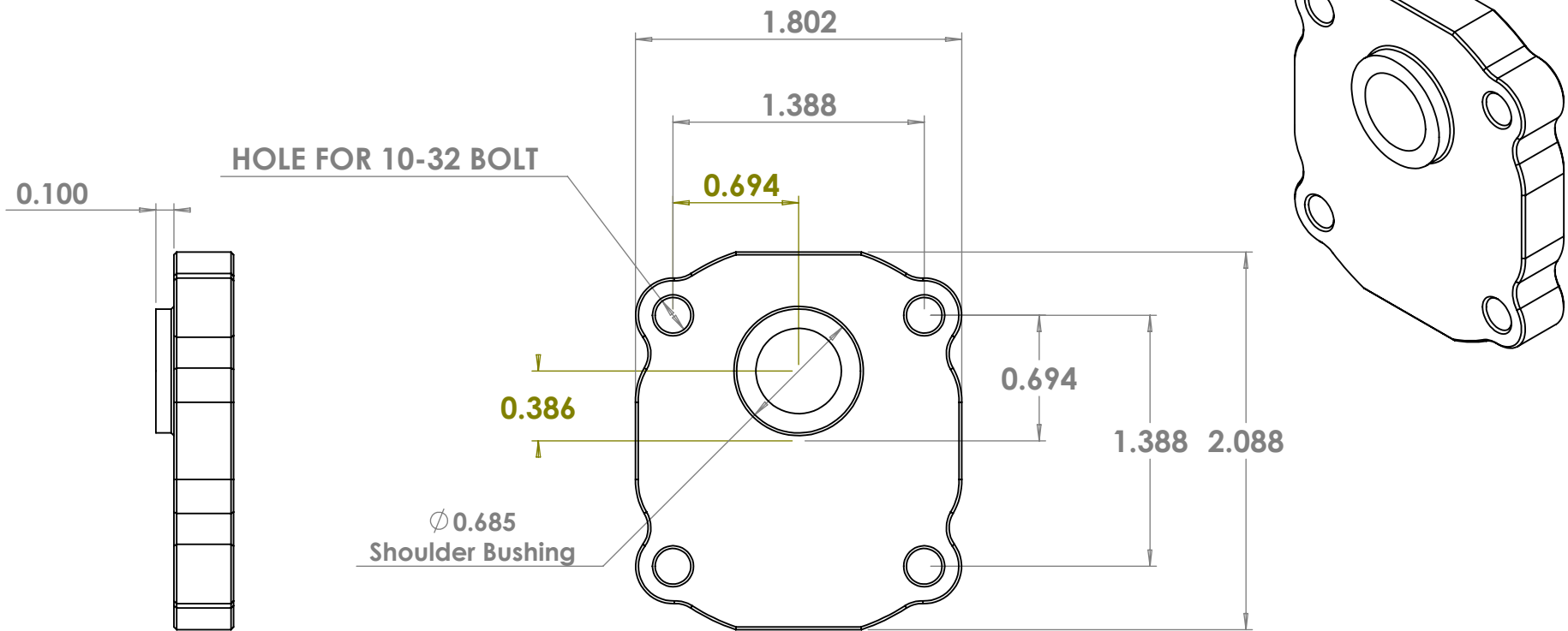

DIRECT DRIVE BUSHING PUMPS:

- 1. SHAFT DIAMETER: .420"
- 2. SHAFT HEX: .372" - .373"
- 3. SHAFT LENGTH FROM FACE OF PUMP:
 - .870" (SPEEDWAY ENG)
 - 1.070" (TIGER)

PROPRIETARY AND CONFIDENTIAL
THE INFORMATION CONTAINED IN THIS
DRAWING IS THE SOLE PROPERTY OF
RACELINE OIL PUMPS. ANY REPRO-
DUCTION IN PART OR AS A WHOLE
WITHOUT THE WRITTEN PERMISSION OF
RACELINE OIL PUMPS IS PROHIBITED.

		DIMENSIONS ARE IN INCHES TOLERANCES: FRACTIONAL ± ANGULAR: MACH ± BEND ± TWO PLACE DECIMAL ± THREE PLACE DECIMAL ±		NAME		DATE	
				DRAWN			
				CHECKED			
				ENG APPR.			
				MFG APPR.			
				Q.A.			
				COMMENTS:			
NEXT ASSY		USED ON		FINISH			
APPLICATION				DO NOT SCALE DRAWING			

RACELINE OIL PUMPS

Differential/Transmission Pump
Bolt Pattern

SIZE **A** DWG. NO. REV.

SCALE:1:1:1 WEIGHT: SHEET 1 OF 1